

BIPV Whole-Roof Data Inventory Solrif

Detail of vertical connection

Wall/fireplace vertical section – bottom connection

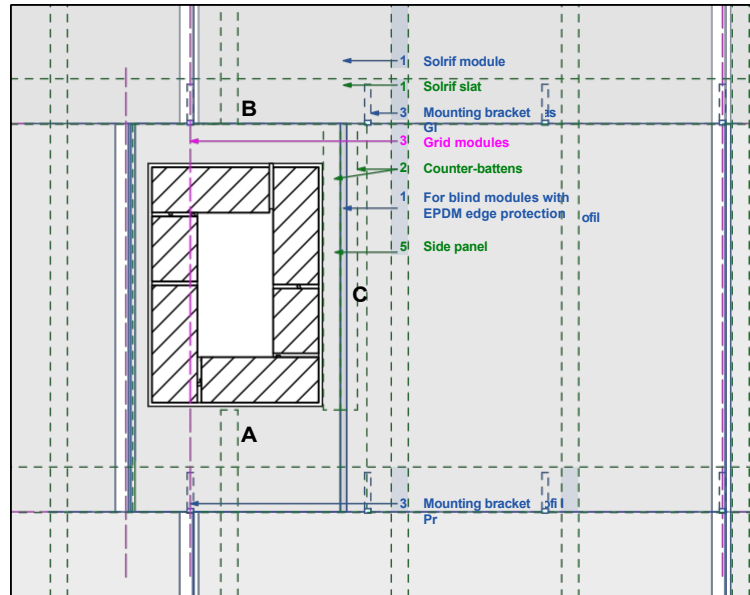

Roof plan view 1:20

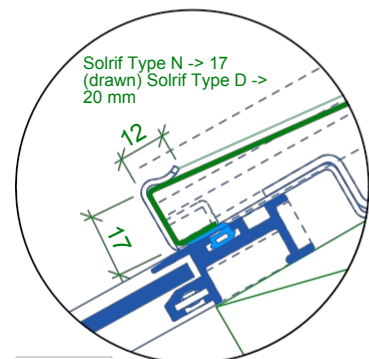

Detail

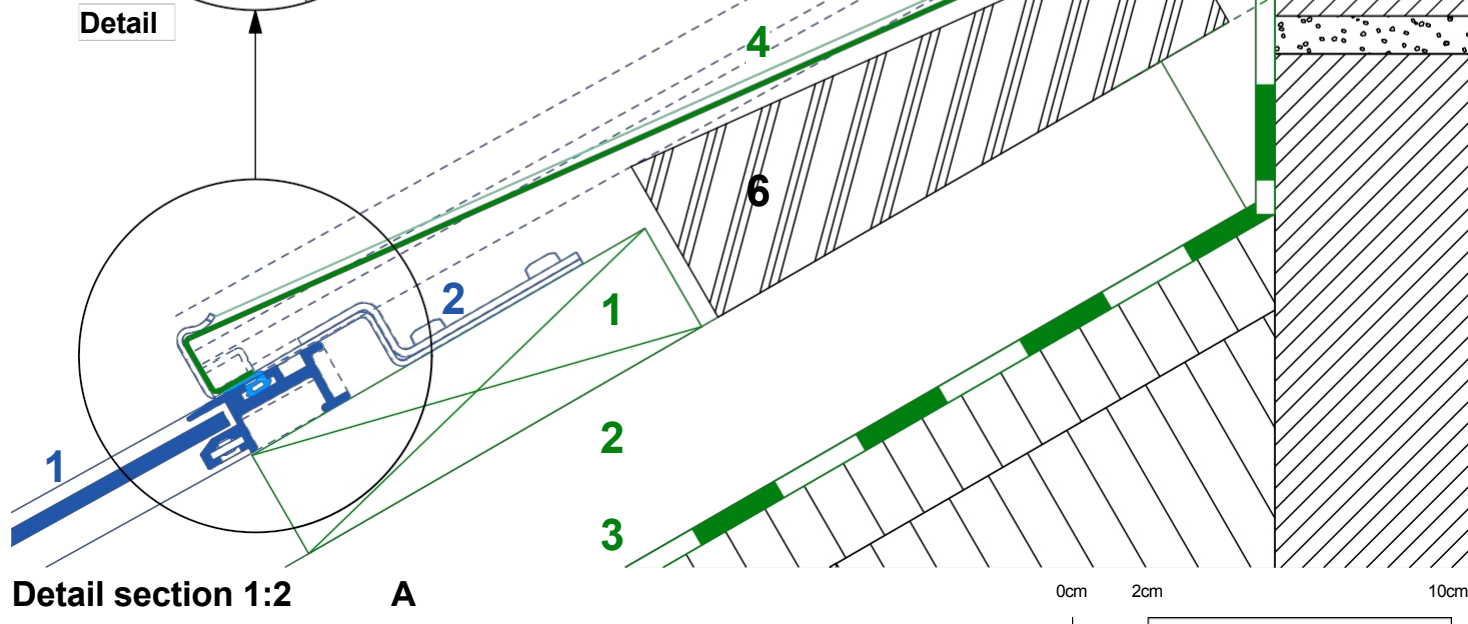

Detail section 1:2 A

IN PROGRESS

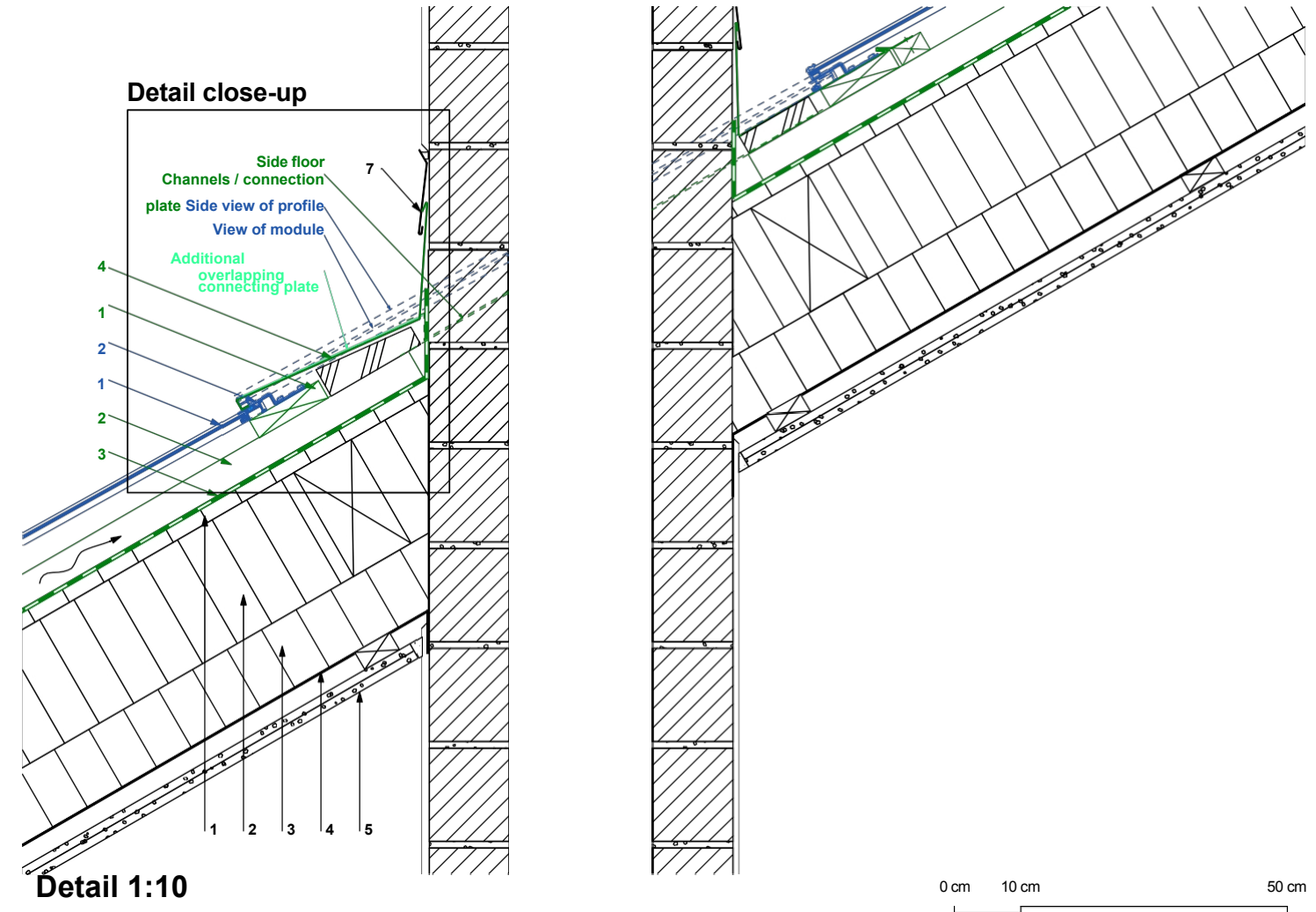

Detail 1:10

Key	
Solrif range:	
1 Solrif module or dummy	
2 module Mounting bracket	
3 Profile Mounting bracket Glass	
System components:	
1 Solrif batten screwed into timber, min. 120 x 30 mm; strength class C24 in accordance with EN 338	
2 Counter-battens (in accordance with the guidelines) / Ventilation space under the roof (depending on the roof pitch, in accordance with the guidelines) Temperature resistance of the membrane: at least 80°C Side flashing	
4	
Construction / Components:	
1 Fibreboard rafters / thermal insulation between the rafters	
2 Thermal insulation beneath the rafters	
3 Vapour barrier	
4 Internal cladding	
5 Timber cladding	
6 Edging sheet with putty strip finish	

Note on applicability: structural connections for Solrif® whole-roof solutions
 © Ernst Schweizer AG. This structural diagram serves as a design concept and a recommendation for safe implementation. Due to national building regulations and regional practices, these must be checked on a project-by-project basis and adapted where necessary. Please note that for Switzerland, the SIA 232/1 standard applies; for Germany, the ZVDH regulations; and for Austria, ÖNROM B 4119:2018 03 'Planning and Construction of Sub-roofs and Underlayments'. In all other respects, the General Terms and Conditions of Ernst Schweizer AG (www.ernstschweizer.ch/agb) apply.

Detail of vertical connection

Wall/flue vertical sec -section – top connection

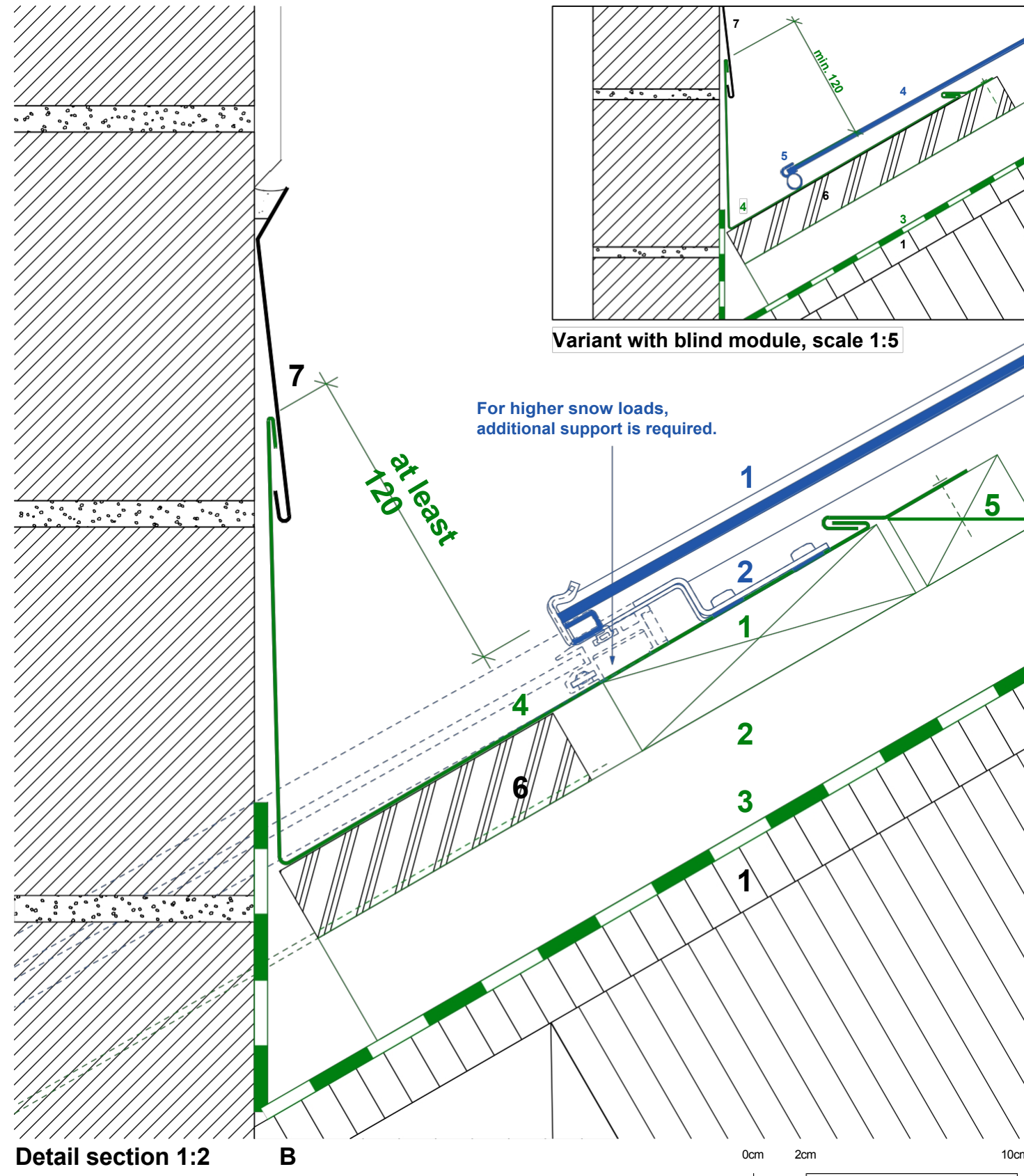

IN PROGRESS

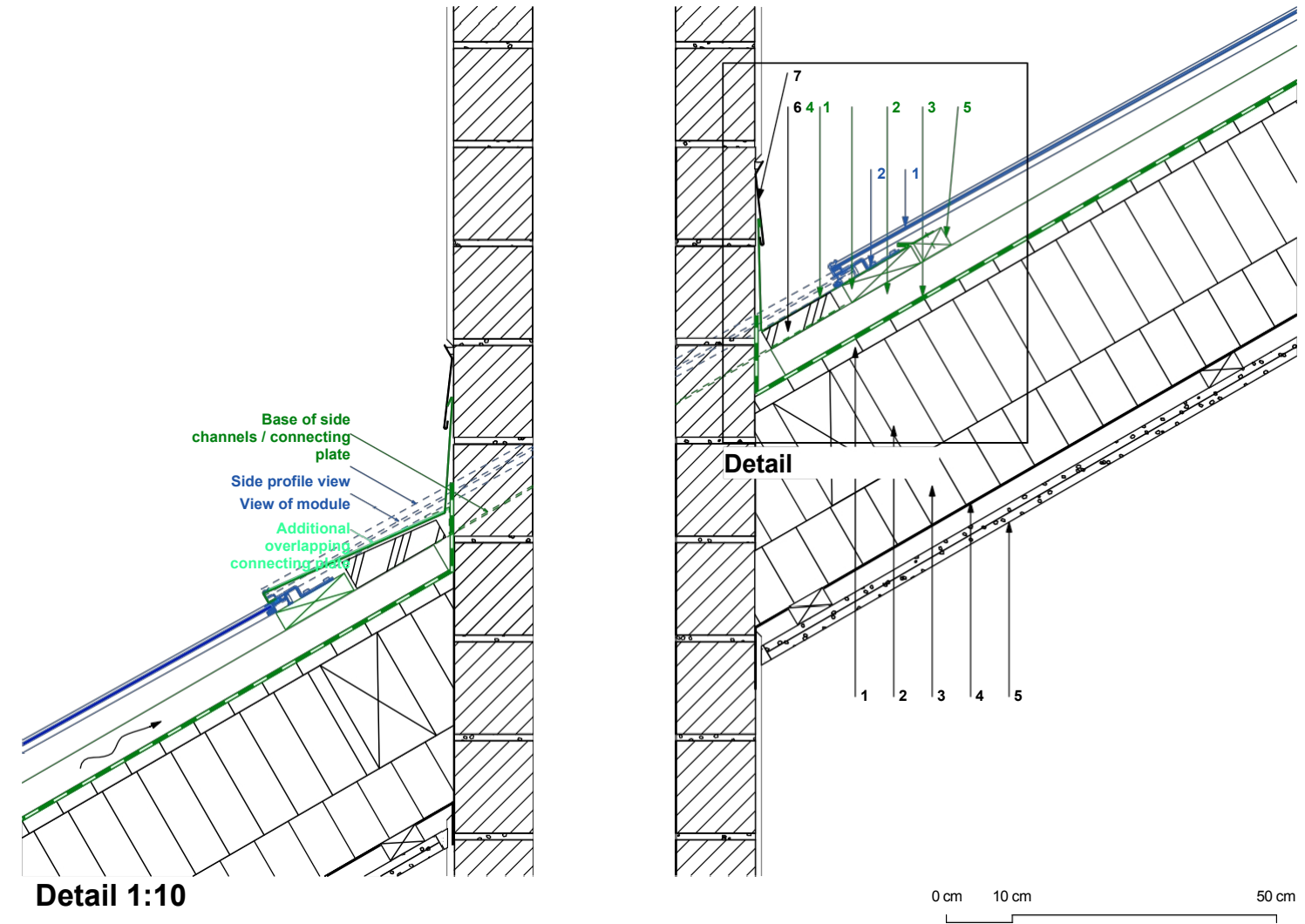

Key

Solrif range:

- 1 Solrif module or dummy module
- 2 Glass mounting bracket, dummy modules
- 3 (dummy) cut with screw seal
- 4 EPDM edge protection profile with steel insert

System components:

- 1 Square timber, 150 x 30 mm, strength class C24 in accordance with EN 338
- 2 Counter-battens (in accordance with the guidelines) / Ventilation
- 3 space under the roof (depending on the roof pitch, in accordance with the guidelines) Temperature resistance of the membrane: at least 80°C
- 4 Side flashing secured with fasteners
- 5 Square timber

Construction / Components:

- 1 Fibreboard rafters /
- 2 thermal insulation between the rafters
- 3 Thermal insulation beneath the rafters
- 4 Vapour barrier
- 5 Internal cladding
- 6 Timber cladding
- 7 Edging sheet with putty strip finish

Note on applicability: structural connections for Solrif® full-roof solutions

© Ernst Schweizer AG. This structural diagram serves as a design concept and a recommendation for safe implementation. Due to national building regulations and regional practices, these must be checked on a project-by-project basis and adapted where necessary. Please note that for Switzerland, the SIA 232/1 standard applies; for Germany, the ZVDH regulations; and for Austria, ÖNROM B 4119:2018 03 'Planning and Construction of Sub-roofs and Underlayments'. In all other respects, the General Terms and Conditions of Ernst Schweizer AG (www.ernstschweizer.ch/agb) apply.